

To: **Tonbridge and Malling Joint Transportation Board**

By: **KCC Highways, Transportation & Waste**

Date: **16 September 2024**

Subject: **A20 Coldharbour Roundabout Junction Improvement**

Classification: **Information Only**

Summary: **This report updates Members on the construction progress of the scheme**

1. Introduction

- 1.1 The A20 Coldharbour roundabout scheme is part of the Maidstone Integrated Transport Programme and 'Keep Maidstone Moving' initiative and is required to relieve existing congestion and support the delivery of local plan sites.
- 1.2 The scheme will create additional capacity at the junction by providing an enlarged conventional unsignalised roundabout, with wider circulatory area, and additional lanes on the approaches to the roundabout. The scheme will also deliver improved drainage infrastructure to alleviate previous flooding issues.
- 1.3 Unfortunately the loss of established planting was necessary to make way for the improved roundabout with the loss of approximately 40 trees. However, this will be mitigated by the planting of approximately 70 new trees at the completion of the scheme.

2. Construction Progress and Programme

- 2.1 The construction contract was awarded to Breheny Civil Engineering Ltd on 4 January 2024 for £4.9m.
- 2.2 Construction commenced on 12 February 2024 with the removal of the vegetation from the central roundabout island and northwest corner of the roundabout.
- 2.3 Work then initially concentrated on the construction of the offline section within the field to the northwest of the roundabout before moving to the online sections and creating the new roundabout and tie-ins to the existing A20 and Coldharbour Lane.
- 2.4 The improvements also necessitated the diversion of Virgin Media and UK Power Networks apparatus.

- 2.4 Works are now well progressed with the carriageway largely complete to the underside of the final surfacing layer. The final surfacing layer and road markings is expected to be completed during October 2024 during a series of night-time road closures.
- 2.5 Works are currently being carried out to complete and surface the adjacent footways throughout the site, along with the preparation of the verge areas for final topsoiling and grass seeding.
- 2.6 Other ancillary works such as traffic signing, street lighting and highway boundary fencing are also due to be completed by the end of October 2024.
- 2.7 It is expected that the site compound will be demobilised at the beginning of November 2024, to allow this area to be reinstated and returned to the landowner.
- 2.8 Landscape planting is expected to commence in early November 2024 and be completed by the end of November 2024.
- 2.9 The scheme is expected to be completed on programme in early December 2024.

3. Background Documents

Appendix A – Drawing No. CLDHBR-CAP-HGN-OO-DR-C-0035 CO2 - A20
Coldharbour roundabout scheme plan.

Report Author

Barry Stiff
Senior Project Manager
Major Capital Programme Team



Looking east towards Coldharbour Roundabout



Looking southeast towards Coldharbour Roundabout



Looking south towards Coldharbour Roundabout



Looking east towards Coldharbour Roundabout

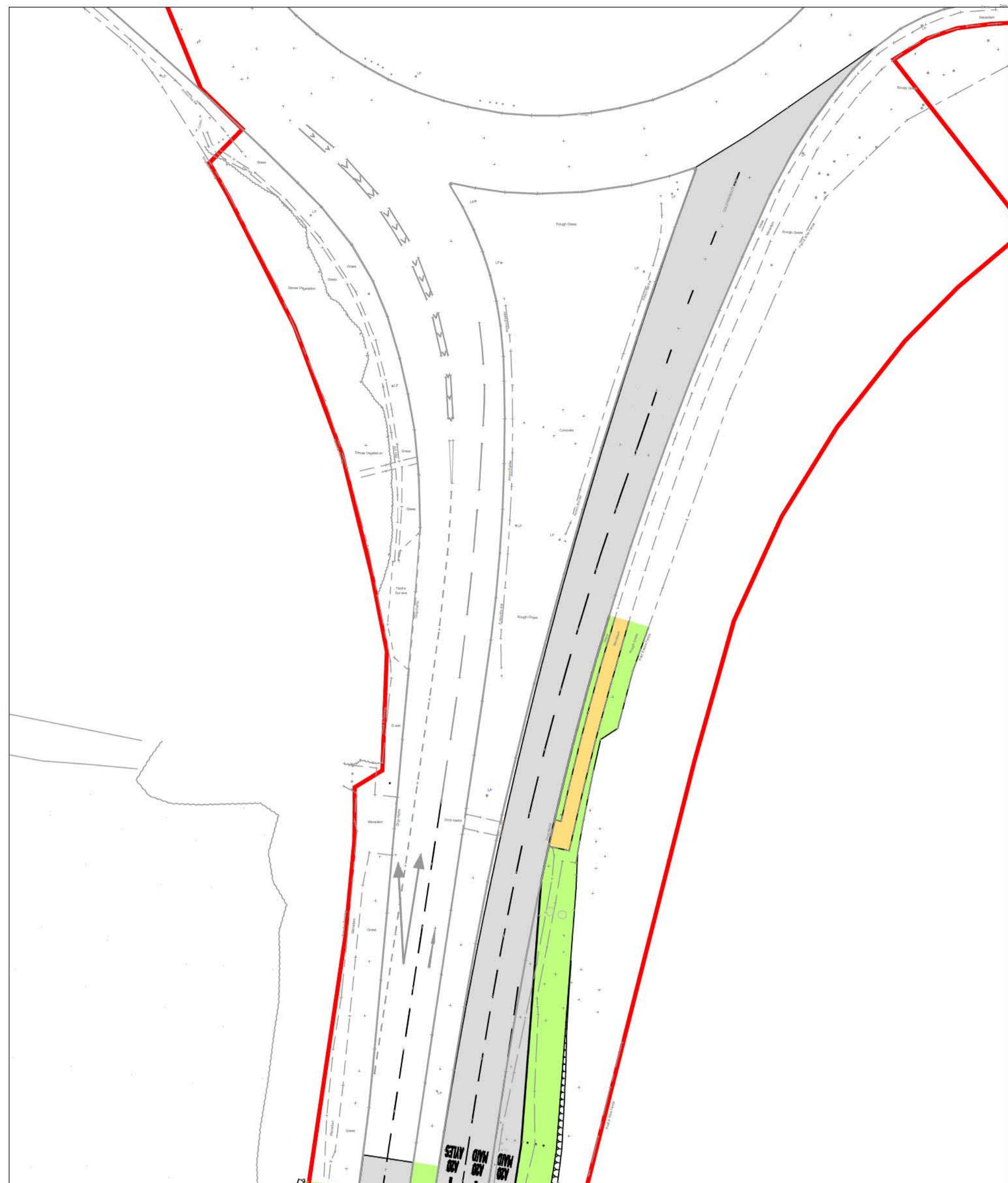
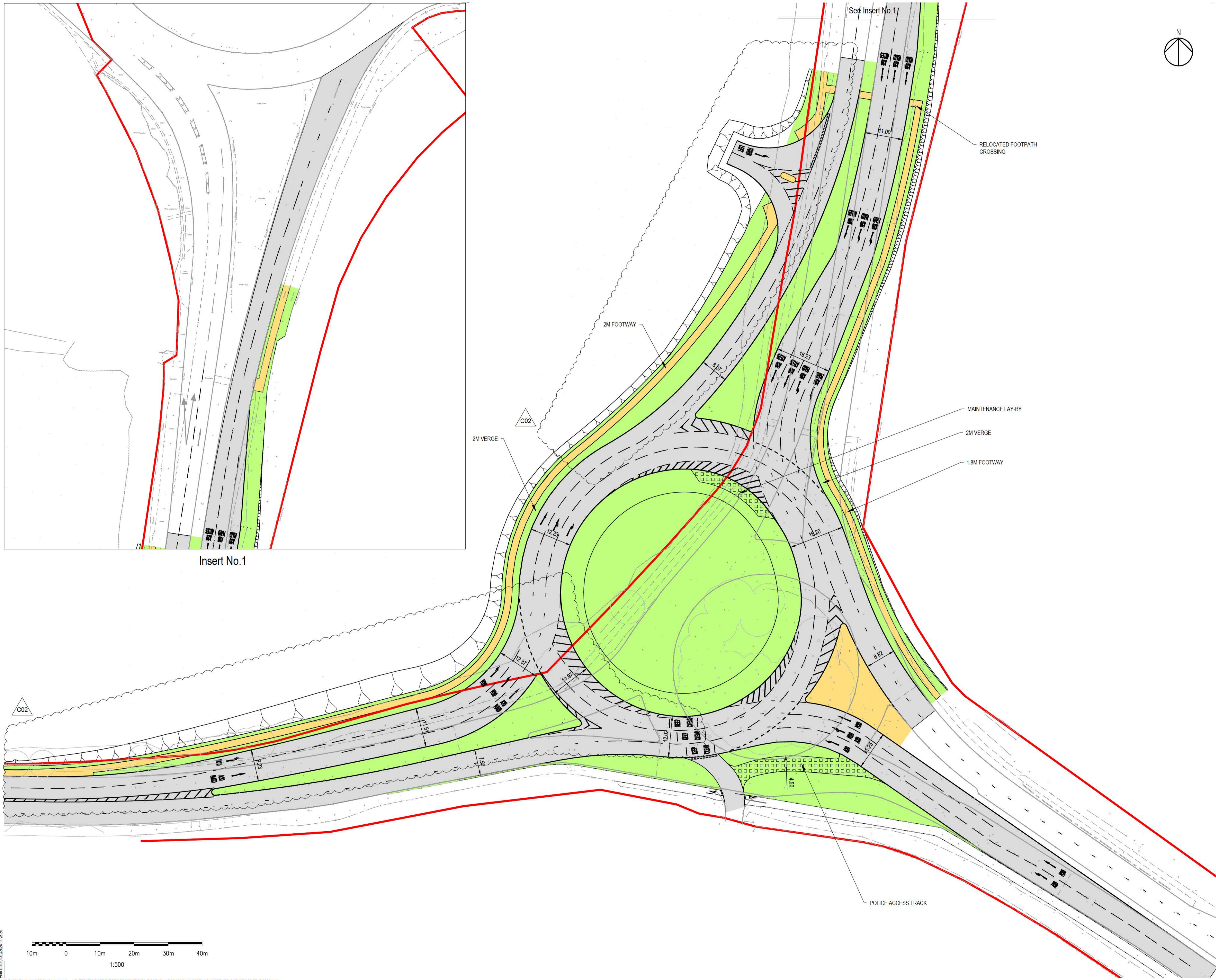

Insert No.1

NOTES:
1. ALL DIMENSIONS IN METRES UNLESS OTHERWISE STATED.

- KEY:
- EXISTING HIGHWAY
 - BOUNDARY CENTRAL ISLAND / VERGE
 - FOOTWAY / SPLITTER ISLAND
 - CARRIAGEWAY

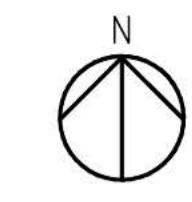

Rev	Drawn	Checked	App'd	Description	Date
C02	ARS	KS	AB	WESTERN AND NORTHERN ARM ALIGNMENT AMENDED	01.02.24
C01	ARS	KS	AB	FOR CONSTRUCTION	19.09.23
P08	BF	KS	AB	POLICE ACCESS TRACK ADDED	02.12.22
P07	JB	KS	AB	COLDHARBOUR LAND SOUTHBOUND LHS KERB ALIGNMENT AMENDED	25.02.22
P06	KS	KS	KS	DIMENSIONS AMENDED	18.09.21
P05	AS	KS	AB	TENDER ISSUE	01.06.21
P04	CS	AZ	KS	ROAD MARKINGS ADDED	18.09.19
P03	AS	KS	KS	RBL ACCESS ADDED AND FOOTWAY AMENDED	06.09.19
P02	CS	AZ	KS	MINOR AMENDMENTS	26.07.19
P01	LR	KS	AB	FIRST ISSUE	03.04.19

Purpose of Issue
For Construction **A**

Classification
Commercial in Confidence



Project
Coldharbour Roundabout

Drawing
General Arrangement

Scale @ A1	Drawn	Checked	Approved
1:500	CS	KS	AB

Project No.	Date
CS096347	04-03-19

Drawing Identifier	BS1192 Compliant
CLDHBR-CAP-HGN-00-DR-C-0035	revision C02

CAPITA
Highways
Capita House, Wood Street, East Grinstead, RH19 1UJ
01342 327161
www.capitaproperty.co.uk
Capita Property and Infrastructure Ltd.

