









KEY:

-  Site Boundary
-  Existing hedge to remain
-  Existing tree to remain
-  Existing tree to be felled as Arboricultural Report.
-  Existing hedge to be removed - H4 (as per Arboricultural Impact Assessment 1) consisting of Common Hawthorn and Common Hazel. Length 342m.
-  Existing hedge to be removed - H3 (as per Arboricultural Impact Assessment 1) consisting of hawthorn. Length 22m.
-  Existing hedge to be removed - H7 (as per Arboricultural Impact Assessment 1) consisting of Common Hawthorn and Common Hazel. Length 70m.
-  Proposed hedge to be planted consisting of hawthorn, hazel, blackthorn and oak with an offset of 0.5m from the new fence line.
-  Existing verge.



| | | | | | |
|-----|---------------|---------------------|-------|---------|--------|
| 0 | 26.09.24 | First Issue | AEC | SH | SH |
| Rev | Revision Date | Purpose of revision | Drawn | Checked | Appr'd |

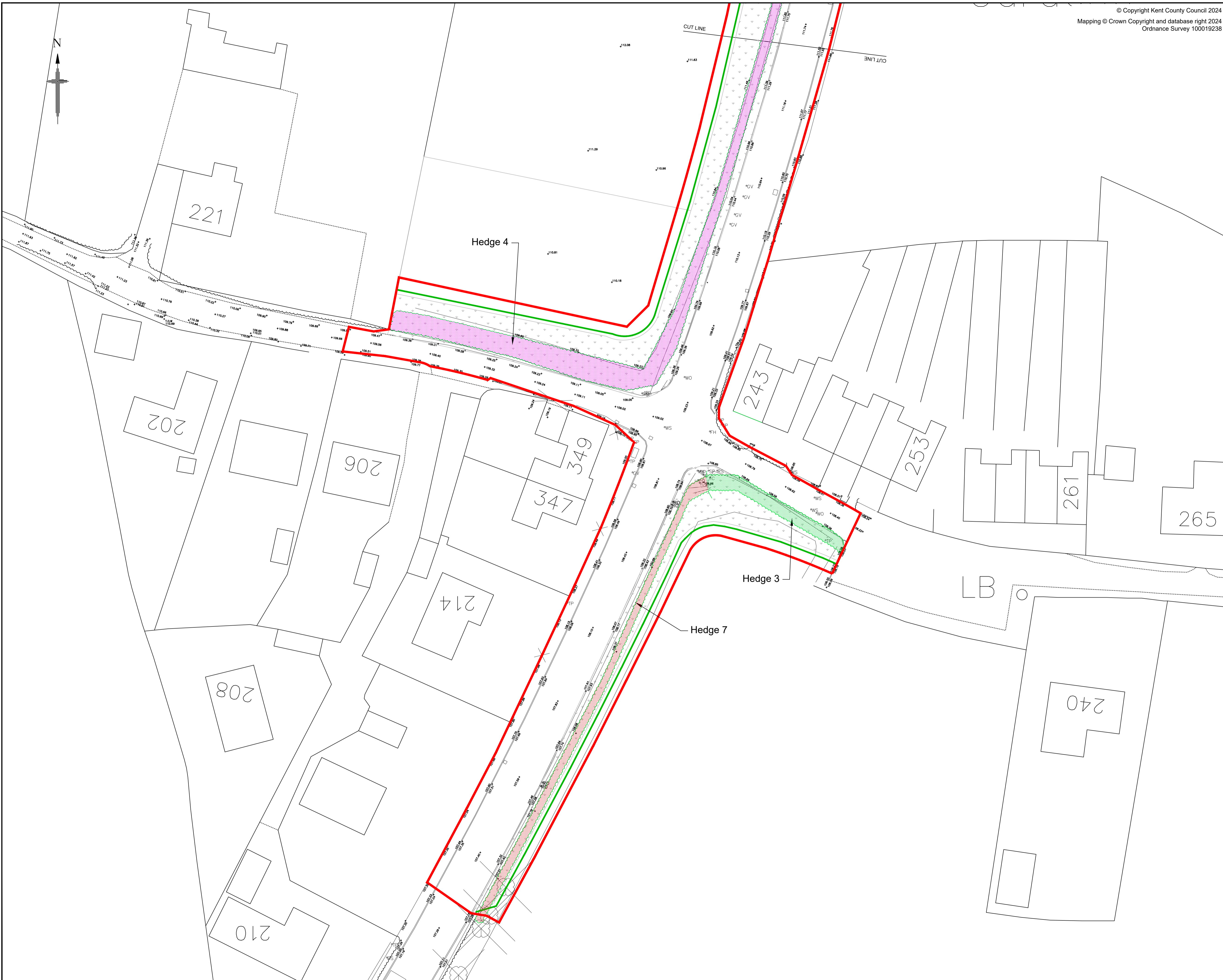

Kent County Council
 kent.gov.uk



Kent County Council
 Ashford Highway Depot
 Henwood Industrial Estate
 Ashford
 TN24 8AD
 Tel: 03000 418181

Project
**A228 Malling Road/KentStreet
 Tonbridge & Malling**

Drawing title
**Hedge Removal
 Notice Plan**

Drawing status
Construction

Scale
1:250 at A1 Do not scale

Drawing number
2232-S106-TM-01-HRN-01 Rev **0**

This drawing is not to be used in whole or part other than for the intended purpose and project as defined on this drawing. Refer to the contract for full terms and conditions.



Allotment
Garden

© Copyright Kent County Council 2024
Mapping © Crown Copyright and database right 2024
Ordnance Survey 100019238

- Notes
- All dimensions are proposed and in metres unless otherwise stated.
 - This drawing has been used for information only purposes for the Hedge Removal Notice application.
 - Arboricultural Report referred to in the key is titled *Kent Street Junction Improvements, Tonbridge & Malling Arboricultural Impact Assessment - December 2022*.

- KEY:
- Site Boundary
 - Existing hedge to remain
 - Existing tree to remain
 - Existing tree to be felled as Arboricultural Report.
 - Existing hedge to be removed - H4 (as per Arboricultural Impact Assessment 1) consisting of Common Hawthorn and Common Hazel. Length 342m.
 - Existing hedge to be removed - H3 (as per Arboricultural Impact Assessment 1) consisting of hawthorn. Length 22m.
 - Existing hedge to be removed - H7 (as per Arboricultural Impact Assessment 1) consisting of Common Hawthorn and Common Hazel. Length 70m.
 - Proposed hedge to be planted consisting of hawthorn, hazel, blackthorn and oak with an offset of 0.5m from the new fence line.
 - Existing verge.

| | | | | | |
|-----|---------------|---------------------|-------|---------|--------|
| 0 | 26.09.24 | First Issue | AEC | SH | SH |
| Rev | Revision Date | Purpose of revision | Drawn | Checked | Appr'd |



Kent County Council
Ashford Highway Depot
Henwood Industrial Estate
Ashford
TN24 8AD
Tel: 03000 418181

Project
**A228 Malling Road/KentStreet
Tonbridge & Malling**

Drawing title
**Hedge Removal
Notice Plan**

Drawing status
Construction

Scale
1:250 at A1 Do not scale

Drawing number
2232-S106-TM-01-HRN-02 0

This drawing is not to be used in whole or part other than for the intended purpose and project as defined on this drawing. Refer to the contract for full terms and conditions.