

From: [Des Keers](#)
To: [Andy Bracey](#)
Cc: [Martin Coffin](#); [Andy Edwards](#); [Robert Styles](#)
Subject: Re: Parking Action Plan - Phase 15
Date: 14 February 2025 17:03:58

Dear Andy,

Thank you for sight of these plans and proposals. Whilst i am aware of all of the issues highlighted, the only one that i am a little concerned with is Hallsfield Road and the introduction of a resident permit scheme.

I would welcome feedback on your consultation work on this one in particular as i feel that the others maybe less of an issue. There may be a few in Robin Hood Lane that see parked vehicles as a speed deterrent but most will be supportive in the areas that you highlight.

Thank you again for your update and i look forward to further updates after the consultation.

Kind Regards
Des

Sent from [Outlook for iOS](#)

From: Andy Bracey <Andy.Bracey@tmhc.gov.uk>
Sent: Friday, February 14, 2025 2:22:26 PM
To: Des Keers <Des.Keers@tmhc.gov.uk>
Cc: Martin Coffin <Martin.Coffin@tmhc.gov.uk>; Andy Edwards <Andy.Edwards@tmhc.gov.uk>; Robert Styles <Robert.Styles@tmhc.gov.uk>
Subject: Parking Action Plan - Phase 15

Dear Ward Member for Walderslade

Hallsfield Road

Residents have asked that the existing single yellow line restrictions that deter commuters be removed and be replaced with a residents parking scheme.

With this in mind we are proposing the introduction of such a scheme. It should be noted that resident permit parking schemes incur new costs on residents who wish to park on the road. Accordingly we are asking those in the local area for their views.

Details of the proposals are shown on the enclosed plan reference DD607-26 Walderslade - Hallsfield Road.

Robin Hood Lane

Concerns have been raised about obstructive parking on the bends in Robin Hood Lane, and around the end of the cul-de-sac, where driveways are obstructed.

To address this we are proposing new double yellow lines to prevent obstructive parking. Accordingly we are asking those in the local area for their views.

Details of the proposals are shown on the enclosed plan reference DD607-27 Walderslade - Robin Hood Lane.

Woodbury Road

Concerns have been raised by residents about obstructive parking on Woodbury Road.

To address this we are proposing new double yellow lines (in accordance with the requirements of the Highway Code). Accordingly we are asking those in the local area for their views.

Details of the proposals are shown on the enclosed plan reference DD607-28 Walderslade - Woodbury Road.

This informal consultation runs from 18th February 2024 and if you wish to comment (either in support or against the proposals) it would be appreciated if you could return your comments by 16th March 2024. We will then collate and review the responses and consider the next steps.

Andy Bracey FIHE
Parking Manager
Street Scene, Leisure & Technical Services

A note about how your personal data is used: As your councillor, I am the “data controller” of any personal data you provide to me. I will use this personal data to enable me to deal with your query or matter. This may also require me to share your personal data with Tonbridge & Malling Borough Council to make sure your query gets handled appropriately. If you have any questions about how your personal data is used, please let me know. For full details about your data rights and about how I will process your personal data please see the Councillors’ privacy notice which can be found [here](#)

Location – Walderslade - Robin Hood Lane

Consultation response – Phase 15 Online-231

I support the proposed changes for Walderslade - Robin Hood Lane

Comments

Vehicles parking on bends ,speeding over the 30mph limit whilst travelling to Fostingtonway from Taddington wood lane,using Robin Hood Lane as a rat run,no thought for other road users at all,would it be possible to put a single yellow line also with restrictions in the cul de sac up to the footbridge as well ,as there is a possibility those who park in Robin Hood Lane on the bends ,will be looking to park in this stretch of road.

Location – Walderslade - Robin Hood Lane

Consultation response – Phase 15 Online-374

I object to the proposed changes for Walderslade - Robin Hood Lane

Comments

I agree that some restrictions would be appropriate subject to the following observations:

The road between the recreation space access and Fostington Way junction is often busy partly because there appears to be some car related commercial activity around numbers 152/154. The small cul de sac next to the junction is always full during the day probably partly commuter related. It often overflows to the main road.

Additionally the road between the recreation space access and my cul de sac (I live at [REDACTED] RHL) is generally pretty empty. In fact I seldom see any cars on the south side of the road and I travel along it 3 or 4 times a day.

My main concern is about any displacement following any further restrictions introduced. My cul de sac always has at least as many cars parked in it as the stretch of road under consideration even though most of the houses next to me have ample off road parking.

Parking is on both sides of the road and often partly on the pavement making access very difficult at times. Diverted short term visitors would have to find an alternative and that would be the cul de sac where I live. I accept the need for some restrictions in the cul de sac turning circle next to the footbridge but fear that this reduction in parking space would have serious consequences for all the houses here.

This will need to be addressed or the problem will be simply transferred from one place to another.

Location – Walderslade - Robin Hood Lane

Consultation response – Phase 15 Online-466

I object to the proposed changes for Walderslade - Robin Hood Lane

Comments

The proposed double yellow lines in the cul-de-sac would force people to park a few yards down such as outside houses 179, 171a, 171, 167, 202 etc. This would result in parking on both sides of the road and make it difficult to get out at times without narrowly avoiding hitting a parked car. An emergency vehicle would also not be able to get through. Probably better to make it no

waiting during a certain time (such as the other part of Robin Hood Lane near the crematorium) or introduce resident parking only.

Location – Walderslade - Robin Hood Lane

Consultation response – Phase 15 Online-298

I support the proposed changes for Walderslade - Robin Hood Lane

Comments

We support the proposals but it needs to include the part of Robin Hood Lane which includes numbers 125 to 137. If this is not included, the regular parked vehicles will simply use our small road in front of these houses making it very difficult to access our properties. Bollards would also need to be installed around the grass area in front of these addresses to prevent parking on the grass verge.

Location – Walderslade - Robin Hood Lane

Consultation response – Phase 15 Online-115

I object to the proposed changes for Walderslade - Robin Hood Lane

Comments

As a resident on the road in question I object to the proposal for Robin Hood Lane, as I believe it covers too wide a stretch of the road and is largely unnecessary.

As far as we are aware, from living on the road for over 10 years, the problem points for parking are:

1. At the junction with Fostington Way - where cars are sometimes parked too close to the junction and cars tend to come round the corner at high speed (as the speed limit drops from 40mph just before it).
2. The cul-de-sacs at the top and bottom of this section of the road - where parked vehicles do sometimes appear to obstruct residents' driveways.

However, the real issue with the road is not any on-road parking (which is often necessary for many residents themselves, their visitors and deliveries etc.), but rather the speed at which other people drive up and down the road. Many times I have had difficulties getting off my driveway safely, due to the excessive speed of vehicles travelling on the road around the bend. It is also unsafe for my children to cross the road themselves, for example, when they walk to and from school. It is also a particular issue at rush hour when many people speed up the road, using it as a "rat run" to avoid the traffic on Fostington Way.

In our experience, our neighbours and their guests generally park with consideration and try not to obstruct anyone else's driveways nor any other drivers using the road.

I will again re-iterate that it is the speed of vehicles travelling on this section of road that is the most pressing issue. Indeed, this very problem has been raised previously with TMBC by residents of the road, with no action/measures ever taken to try to reduce the speed of traffic here. My question is why should the residents of this stretch of road be penalised because others want to use it as a "rat run"?

I would urge you to reconsider these proposals, perhaps with the exception of the part near the junctions and the cul-de-sacs (if those residents believe there to be an issue). Please instead consider more appropriate measures to reduce the speed of drivers using this stretch of road, as this will have a much more positive impact for residents, including my children, than any parking restrictions will have. Thank you.

Location – Walderslade - Robin Hood Lane

Consultation response – Phase 15 Online-401

I object to the proposed changes for Walderslade - Robin Hood Lane

Comments

I believe if Robin Hood Lane was to have double yellow lines it would make the situation worse. The parking of vehicles on the bends are dangerous but this does slow down the traffic. I am worried if there are no restrictions that it would come more of a race track than it is at the moment, this is because of the amount of speeding vehicles that use the road as a cut through. I am also worried if there is no where to park, the small grass area outside my house will be used as parking

Location – Walderslade - Robin Hood Lane

Consultation response – Phase 15 Online-100

I support the proposed changes for Walderslade - Robin Hood Lane

Comments

No comments

From: [Gillian Bull](#)
To: [Parking Office](#)
Subject: Robin Hood Lane DD607-27
Date: 27 February 2025 09:44:44

Good morning

I am writing to let you know I am not in favour of the proposals to change the on street parking arrangements for the stretch of road close to my property at [REDACTED] Robin Hood Lane. I do however agree that it would make sense to install new double yellow lines near the junction at the bottom of the road and I have every sympathy with the people living in the cul-de-sac.

We have never had a problem with parking outside our property and would hope that delivery drivers will still be able to stop for a short period of time. The same applies to people using the bookswap as this a well used community facility.

Regards

[REDACTED]

This email has been scanned by TMBC before delivery to your mailbox. Please click [here](#) to report this email as spam and help train the filter.

From: [REDACTED]
To: [Parking Office](#)
Subject: Ref: DD607-27 Walderslade-Robin Hood Lane
Date: 12 March 2025 14:56:21

Dear Sir/Madam

With reference to the above planned parking restrictions in Robinhood Lane (Lower), I strongly object to the councils proposed plan to install double yellow lines from the junction of Taddington Wood to Fostington Way for the following reasons:

- The reasons for the proposal are obstructive parking on bends and obstructed driveways in the Cul-de-sac but the real reason is that a family in the road continually have 8-10 cars on their drive and parked out on the street during the day and all night. Why don't you just speak to those individuals and stop them running what seems to be a car sales business from home? There are not normally cars parked further up on the bends which is where I live and if you drive down at any time of the day there are no issues.
- By installing double yellow lines you are just opening up the road allowing more people to speed through knowing that there won't be any obstructions adding to what is an already a dangerous road for pedestrians and other road users. Many years ago there was a speed survey completed and the fastest car sped down the road at 77MPH! When the council was approached, the response was that randomly parked cars in the road would slow these speeding drivers as they were natural obstructions legally parked. The council also refused to consider speed humps or closing the road from either end closing what is a 'Rat Run' to the Walderslade Woods road.

Given that some sort of restriction will undoubtedly happen, I would propose the following:

- Double yellow lines installed in the cul-de-sac to prevent obstructive parking and reinstate the turning circle. This will also allow access to the fire hydrant in the road that is normally restricted.
- Double yellow lines installed at the junction and on the bends where the road meets Fostington Way and including the bus stop. This will prevent the commuters parking all day on the kerbs and verges that is unsightly and often dangerous for pedestrians and other road users.
- The remainder of Robin Hood Lane to have Monday-Friday restrictions with a single yellow line and different times either side similar to the part of Robin Hood lane where the crematorium is. Typically no parking from 11.00-12.00 on one side and then 12.00-13.00 on the other.

Please accept my thanks for reading this email and hope that it goes someway to making a better informed decision.

Best Regards

[REDACTED]

[REDACTED]

[REDACTED] Robinhood Lane

Chatham

Kent. ME5 9NL

T. [REDACTED]

M. [REDACTED]

W. [REDACTED]



This email has been scanned by TMBC before delivery to your mailbox. Please click [here](#) to report this email as spam and help train the filter.

From: [REDACTED]
To: [Parking Office](#)
Subject: Ref: DD607-27 Walderslade – Robin Hood Lane
Date: 10 March 2025 14:34:44

Ref: DD607-27 Walderslade – Robin Hood Lane

With reference to your letter (Phase 15-Inf DD607-27 Walderslade – Robin Hood Lane) dated 18th February 2024 which sought responses by 16th March 2024 (which I assume should both be 2025).

I have concerns regarding the proposal (for yet more) new double yellow lines on Robin Hood Lane, as this will lead to cars being forced to park in the side roads (Mercer Court) which then cause an obstruction, particularly if the vehicles are left while the driver obtains a lift and leaves the car all day or they; the driver & passengers decide to go for a walk.

I therefore object to the proposal - NOT IN FAVOUR.

Regards,

[REDACTED]

This email has been scanned by TMBC before delivery to your mailbox. Please click [here](#) to report this email as spam and help train the filter.

From: [REDACTED]
To: [Parking Office](#)
Cc: [Des Keers](#)
Subject: DD607-27 Walderslade - Robin Hood Lane
Date: 14 March 2025 12:57:23
Importance: High

Dear Parking Team,

Re: Proposal DD606-27 Walderslade - Robin Hood Lane

I would like to make the following points:

- The proposal to introduce double yellow lines along the whole of Robin Hood Lane between Taddington Wood and Fostington is excessive if the problem is on the bends and around the end of the cul-de-sac.
- If nothing is allowed to park except for dropping off and deliveries, then the road will become a race track. It is already used as a cut through to the Bridgewood Roundabout. Speed along the road will increase as there will be nothing to slow vehicles down. This is extremely dangerous for pedestrians crossing the road. Many people use our road to walk to Bluebell Hill and into Taddington Wood - families with children, some in pushchairs, and older relatives; joggers; walkers; postal workers and so on. We have often struggled to cross in time when a fast car has rocketed around the top bend and down the road.
- Most of us have already paved or concreted at least part of our drives to enable off-road parking for families and friends as well as ourselves. But if this proposal goes ahead there will be an added environmental danger - residents will be forced to 'soil seal' the whole of their drives. The 'dip' in our road already floods regularly - it will definitely get worse if we are forced to cover the green parts of our gardens that are still left. The wildlife will suffer too.
- The best solution as far as I can see would be to repeat what you did in Tunbury Avenue - from Fostington to Tunbury School. There is a parking restriction for one hour in the day each side of the road - eg 12-1pm on one side; 1-2pm on the other. This system works really well. There is no commuter parking.
- I don't understand why this restriction is proposed to be 24/7? If the problem is during the daytime why extend it to overnight? I honestly don't understand why this is being proposed.

Best regards,

[REDACTED]
[REDACTED] Robin Hood Lane
Walderslade
ME5 9LA
[REDACTED]

This email has been scanned by TMBC before delivery to your mailbox. Please click [here](#) to report this email as spam and help train the filter.

From: [REDACTED]
To: [Parking Office](#)
Cc: [Des Keers](#)
Subject: Proposed Parking Restrictions : Ref DD607-27 Walderslade – Robin Hood Lane
Date: 10 March 2025 19:37:51
Importance: High

Proposed Parking Restrictions : Ref DD607-27 Walderslade – Robin Hood Lane

Dear Sirs,

Thank you for the opportunity to provide consultation feedback on these proposals.

I am very much opposed to the current proposals applying to the whole length of road, which seems disproportionate and excessive for the situation.

While it may (though not certainly) be necessary to introduce some restrictions around the footbridge turning area and/or the Fostington Way junction, I do not think restrictions are needed along the rest of the road.

This is a residential area, where most residents are car users. Although most properties have driveways (and these are used), cars parked on the road are to be expected – for visitors, carers, tradespeople etc. With a complete ban on roadside parking – where will visitors be expected to leave their cars? This is a practical question which needs to be answered.

Although I know that the road is used as a “rush hour rat run” when there are queues around the Fostington Way/Walderslade Woods road area, for most of the day (more than 20 hours) Robin Hood Lane is a very quiet road, so there really is no need for a 24 hour/7 day parking restriction.

In nearby Tunbury Avenue there is a single yellow line restriction for a staggered one-hour period each day on each side of the road – which is very effective in preventing all-day commuter parking. This should be considered for Robin Hood Lane, if any restrictions at all are deemed to be necessary.

There is generally very good visibility along the road. The presence of parked cars in the road acts as a natural traffic calming measure, requiring drivers to maintain concentration and moderate their speed.

If the road were cleared of these “obstructions” I fear the road would become more of a “race track” and encourage more use as a rat run throughout the day - by non-residents, potentially paying less attention to the speed limit and residential considerations. This would make the road more dangerous for cars entering and leaving driveways, and pedestrians crossing the road. Many pedestrians (including school children, dog walkers and the elderly) use the road for walking to and from Bluebell Hill and Taddington Valley.

While it may be possible (though not necessarily affordable) for some residents to expand their driveways to accommodate additional parking, this would lead to more “soil sealing” and rainwater run-off issues. After heavy rain there is already frequent flooding of the “dip” near the entrance to Taddington Valley (between properties 156 and 160). This

situation would only be worsened.

For all of the above reasons I am NOT in favour of the Borough Council's proposals.

Regards

[REDACTED]

[REDACTED] Robin Hood Lane

ME5 9LA

This email has been scanned by TMBC before delivery to your mailbox. Please click [here](#) to report this email as spam and help train the filter.

Informal Consultation
New & Amended Parking Restrictions
Robin Hood Lane (and cul-de-sac), WALDESLADE, CHATHAM

Please return this form to;

The Parking Team
 Tonbridge & Malling Borough Council
 Gibson Building, Gibson Drive
 Kings Hill, West Malling
 Kent ME19 4LZ

Alternatively, responses can be sent via email to parking.office@tmbc.gov.uk, quoting reference DD607-27 Walderslade - Robin Hood Lane.

Want to go digital? You can view the proposals and respond online by visiting www.tmbc.gov.uk/parkingphases or scanning this QR code



All responses must be received by 16th March 2024.

Data protection

Please remember that any comments made may be used within reports to Councillors and within documents that may be made available to the public, though any personal information will be protected.

If you would like more information about how we use your data, please read our Privacy Statement on our website www.tmbc.gov.uk/parking

Name (please print)	
Address	ROBIN HOOD LANE WALDESLADE CHATHAM KENT ME5 9NL
Telephone	
Email	

I am (in favour / ~~not in favour~~)* of the Borough Council's proposals for changes to the on-street parking arrangements for Robin Hood Lane (and cul-de-sac), WALDESLADE, CHATHAM shown on plan DD607-27 Walderslade - Robin Hood Lane

* delete where not applicable

Comments	
We have been asking for this for over a year. The parking is dangerous in this road and near misses are common. I notice this letter is dated 2024 but we have received it TODAY!	
Signed	Date 21 Feb. 2025

Informal Consultation
New & Amended Parking Restrictions
Robin Hood Lane (and cul-de-sac), WALDESLADE, CHATHAM

Please return this form to;

The Parking Team
 Tonbridge & Malling Borough Council
 Gibson Building, Gibson Drive
 Kings Hill, West Malling
 Kent ME19 4LZ

Alternatively, responses can be sent via email to parking.office@tmbc.gov.uk, quoting reference DD607-27 Walderslade - Robin Hood Lane.

Want to go digital? You can view the proposals and respond online by visiting www.tmbc.gov.uk/parkingphases or scanning this QR code



All responses must be received by 16th March 2024.

Data protection

Please remember that any comments made may be used within reports to Councillors and within documents that may be made available to the public, though any personal information will be protected.

If you would like more information about how we use your data, please read our Privacy Statement on our website www.tmbc.gov.uk/parking

Name (please print)	[REDACTED]
Address	ROBIN HOOD LANE WALDESLADE CHATHAM KENT ME5 9NJ
Telephone	[REDACTED]
Email	[REDACTED]

I am (in favour / ~~not in favour~~)* of the Borough Council's proposals for changes to the on-street parking arrangements for Robin Hood Lane (and cul-de-sac), WALDESLADE, CHATHAM shown on plan DD607-27 Walderslade - Robin Hood Lane

* delete where not applicable

Comments	
I THANK YOU FOR YOUR CONSULTATION LETTER. PARKING IN THE ROBIN HOOD LANE CULDE SAC IS BECOMING MORE OF A PROBLEM AS WITH NEW PEOPLE MOVING IN RECENTLY - MORE SEEM TO BE RUNNING BUSINESSES FROM HOME, HENCE PARKING ISSUES. I WOULD LIKE TO SEE YELLOW LINES THROUGHOUT THE CUL DE SAC	
Signed	Date 14/3/25

OR A 2 HOUR PARKING RESTRICTION SAT IN THE
 MIDDLE OF THE DAY - PREVENTING PEOPLE PARKING ALL DAY
 AND TRAVELLING TO WORK IN A CAR SHARE ETC.

To The Parking Team
Tonbridge & Malling Borough Council
Gibson Building Gibson Drive
Kings Hill, West Malling
Kent ME19 4LZ

Date 3/3/2025

From [REDACTED]
[REDACTED] Robin Hood Lane
(cul-de-sac)

New double yellow lines and to prevent obstructive parking
Robin Hood Lane (and cul-de-sac) WALDERSLADE Walderslade Ward

We who live in the cul-de-sac in Robin Hood Lane need the double yellow lines to continue down the cul-de-sac. The reason is that at present we have vehicles parking both sides of the road. Some vehicles park overnight. The vehicles that now park on the houses side (our house side) park up on the pavement which is a hazard to pedestrians, pushchair users and disability scooters. With the new parking restrictions in Robin Hood Lane and the entrance to the cul-de-sac this will encourage more vehicles to park outside our properties causing more congestion and obstruction. We already regularly have difficulty getting out of the cul-de-sac as it is a narrow road. Vehicles parking both sides means the emergency services would not be able to get through to our houses in an emergency [REDACTED] properties 136, 138 and 144) already have difficult access problems in and out of the cul-de-sac due to the narrow part of the road that is left for us to drive through.. Large delivery vehicles are obstructive and cannot turn round and sometimes the refuse trucks do not enter the cul-de-sac due to the parking issues and the dustbin people have to take our bins to the end of the cul-de-sac to empty them. We in the cul-de-sac think all these points should be taken into consideration to prevent obstruction issues in the future. Thank you

Informal Consultation
New & Amended Parking Restrictions
Robin Hood Lane (and cul-de-sac), WALDESLADE, CHATHAM

Please return this form to;

The Parking Team
 Tonbridge & Malling Borough Council
 Gibson Building, Gibson Drive
 Kings Hill, West Malling
 Kent ME19 4LZ

Alternatively, responses can be sent via email to parking.office@tmbc.gov.uk, quoting reference DD607-27 Walderslade - Robin Hood Lane.

Want to go digital? You can view the proposals and respond online by visiting www.tmbc.gov.uk/parkingphases or scanning this QR code



All responses must be received by 16th March 2024.

Data protection

Please remember that any comments made may be used within reports to Councillors and within documents that may be made available to the public, though any personal information will be protected.

If you would like more information about how we use your data, please read our Privacy Statement on our website www.tmbc.gov.uk/parking

Name (please print)	[REDACTED]
Address	ROBIN HOOD LANE WALDESLADE CHATHAM KENT ME5 91 B (Cul-de-sac)
Telephone	[REDACTED]
Email	[REDACTED]

I am **(in favour / ~~not in favour~~)*** of the Borough Council's proposals for changes to the on-street parking arrangements for Robin Hood Lane (and cul-de-sac), WALDESLADE, CHATHAM shown on plan DD607-27 Walderslade - Robin Hood Lane

* *delete where not applicable*

Comments	
We are an elderly couple living in the cul-de-sac in Robin Hood Lane. We have attached our comments to this form.	
Signed	<div style="display: flex; justify-content: space-between;"> <div>[REDACTED]</div> <div>Date 3/3/2025</div> </div>

Informal Consultation
New & Amended Parking Restrictions
Robin Hood Lane (and cul-de-sac), WALDESLADE, CHATHAM

Please return this form to;

The Parking Team
Tonbridge & Malling Borough Council
Gibson Building, Gibson Drive
Kings Hill, West Malling
Kent ME19 4LZ

Alternatively, responses can be sent via email to parking.office@tmbc.gov.uk, quoting reference DD607-27 Walderslade - Robin Hood Lane.

Want to go digital? You can view the proposals and respond online by visiting www.tmbc.gov.uk/parkingphases or scanning this QR code



All responses must be received by 16th March 2024.

Data protection

Please remember that any comments made may be used within reports to Councillors and within documents that may be made available to the public, though any personal information will be protected.

If you would like more information about how we use your data, please read our Privacy Statement on our website www.tmbc.gov.uk/parking

Name (please print)	[REDACTED]
Address	[REDACTED] ROBIN HOOD LANE WALDESLADE CHATHAM KENT ME5 9LA
Telephone	
Email	

I am (**in favour** / ~~not in favour~~)* of the Borough Council's proposals for changes to the on-street parking arrangements for Robin Hood Lane (and cul-de-sac), WALDESLADE, CHATHAM shown on plan DD607-27 Walderslade - Robin Hood Lane

* *delete where not applicable*

Comments	
NEW PARKING RESTRICTIONS WOULD BENEFIT ME, MAKING MY LINE OF SIGHT CLEARER & SAFER WHEN LEAVING MY DRIVE, BUT I FEAR THIS MAY ALSO INCREASE THE SPEED OF TRAFFIC TO MORE DANGEROUS LEVELS. A PEDESTRIAN CROSSING SHOULD BE CONSIDERED OUTSIDE OF N°186.	
Signed [REDACTED]	Date 24 FEB '25.

From: [REDACTED]
To: [Parking Office](#)
Subject: DD607-27 WALDERSLADE-ROBIN HOOD LANE
Date: 23 February 2025 10:45:50

Dear Parking Team

We are in general ,in favour of the proposed parking action plan.

However ,we would like to point out the following.

This road is a big cut through for traffic and once the lines are in place and the road is clear ,cars some of which are travelling at least 40 mph and much faster will now be able abuse this road even more.

Consideration should be given for at least a couple of sleeping policeman either side of the dip adjacent to our property to hopefully slow cars down.

Also you are not including the cul de sac for the houses from 137-127 .

This will mean that car owners will simply leave their cars there instead ,all day , opposite peoples drives and up on the kerb on the grass and either side of peoples drives.

Dog walkers also park opposite 137-127 to walk their dogs down the lane and there is a house opposite that has many cars parked outside especially on a weekend which they appear to be fixing. These too will use our cul de sac instead.

Consideration must be given to stopping this happening please.

This could be done by putting up a time restriction to break the day up, or residents only signs and permits issued for the houses within the cul de sac or any other options you can think of.

Kind regards

[REDACTED]
[REDACTED] robin hood lane
chatham
me5 9nl
[REDACTED]

This email has been scanned by TMBC before delivery to your mailbox. Please click [here](#) to report this email as spam and help train the filter.

From: [REDACTED]
To: [Parking Office](#)
Subject: DD607-27 WALDERSLADE-ROBIN HOOD LANE
Date: 06 March 2025 10:16:04

Dear parking team

Just to give you an idea of cars parked and the likely hood of them just moving over to our cul de sac at 137-127 robin hood lane.

Again I would ask that you put restrictions in place in this area.

Kind regards

[REDACTED]
[REDACTED] robin hood lane
Chatham
ME5 9nl

This email has been scanned by TMBC before delivery to your mailbox. Please click [here](#) to report this email as spam and help train the filter.







From: [REDACTED]
To: [Parking Office](#)
Subject: DD607-27 WALDERSLADE-ROBIN HOOD LANE
Date: 04 March 2025 19:45:14

Dear Parking Team

Further to my earlier email, regarding the area you are not encompassing between 137-127 Robin Hood Lane.

Whilst i stick by my earlier ideas regarding some restriction being made , i now feel that the double yellow lines should be implemented in this cul de sac too.

This area must not be left out from the restrictions as otherwise it will be full of cars ,as commuters , work vans , cars from the garage being run from over the road etc will all fill this area.

Please do not leave this area out as it will be a nightmare for the residents living here.

kind regards

[REDACTED]

[REDACTED] robin hood lane

chatham

me5 9nl

This email has been scanned by TMBC before delivery to your mailbox. Please click [here](#) to report this email as spam and help train the filter.

From: [REDACTED]
To: [Parking Office](#)
Subject: Robin Hood Lane parking phase 15
Date: 10 March 2025 16:31:22

I have just submitted some comments via the web page but may have failed to identify myself. My name is [REDACTED] and I live at [REDACTED] RHL in the cul de sac. My comments were generally favourable with some important concerns. I mentioned my address in the submission just sent.

Thanks

[REDACTED]

This email has been scanned by TMBC before delivery to your mailbox. Please click [here](#) to report this email as spam and help train the filter.

Informal Consultation
New & Amended Parking Restrictions
Robin Hood Lane (and cul-de-sac), WALDERSLADE, CHATHAM

Please return this form to;

The Parking Team
Tonbridge & Malling Borough Council
Gibson Building, Gibson Drive
Kings Hill, West Malling
Kent ME19 4LZ

Alternatively, responses can be sent via email to parking.office@tmbc.gov.uk, quoting reference DD607-27 Walderslade - Robin Hood Lane.

Want to go digital? You can view the proposals and respond online by visiting www.tmbc.gov.uk/parkingphases or scanning this QR code



All responses must be received by 16th March 2024.

Data protection

Please remember that any comments made may be used within reports to Councillors and within documents that may be made available to the public, though any personal information will be protected.

If you would like more information about how we use your data, please read our Privacy Statement on our website www.tmbc.gov.uk/parking

Name (please print)	[REDACTED]
Address	[REDACTED] OBIN HOOD LANE WALDERSLADE CHATHAM KENT ME5 9LB
Telephone	[REDACTED] [REDACTED]
Email	[REDACTED]

I am (in favour / ☐) of the Borough Council's proposals for changes to the on-street parking arrangements for Robin Hood Lane (and cul-de-sac), WALDERSLADE, CHATHAM shown on plan DD607-27 Walderslade - Robin Hood Lane

** delete where not applicable*

Comments	
While I am in favour of the proposed parking restrictions, I am strongly of the view that they do not go far enough in that the proposal as it stands will force more vehicles to park in the narrow cul-de-sac itself. The following text and figures set out the reasoning and recommendation for consideration.	
Signed	Date 27 February 2025

**Informal Consultation
New & Amended Parking Restrictions
Robin Hood Lane (and cul-de-sac), WALDESLADE, CHATHAM**

Please return this form to:

The Parking Team
Tonbridge & Malling Borough Council
Gibson Building, Gibson Drive
Kings Hill, West Malling
Kent ME19 4LZ

Alternatively, responses can be sent via email to parking.office@tmbc.gov.uk, quoting reference DD607-27 Walderslade - Robin Hood Lane.

Want to go digital? You can view the proposals and respond online by visiting www.tmbc.gov.uk/parkingphases or scanning this QR code



All responses must be received by 16th March 2024.

Data protection

Please remember that any comments made may be used within reports to Councillors and within documents that may be made available to the public, though any personal information will be protected.

If you would like more information about how we use your data, please read our Privacy Statement on our website www.tmbc.gov.uk/parking

Name (please print)	[REDACTED]		
Address	[REDACTED] ROBIN HOOD LANE WALDESLADE CHATHAM KENT ME5 9LB		
Telephone	[REDACTED]		
Email	[REDACTED]		

I am (in favour [REDACTED]) of the Borough Council's proposals for changes to the on-street parking arrangements for Robin Hood Lane (and cul-de-sac), WALDESLADE, CHATHAM shown on plan DD607-27 Walderslade - Robin Hood Lane

* delete where not applicable

Comments	
See attached	
Signed	[REDACTED]
Date	27/2/2025

Herewith scanned original signature

Tonbridge & Malling Borough Council

Proposal for new double yellow lines to prevent obstructive parking

Figs 1 & 2 show the planned disposition of double yellow lines proposed by TMBC – it can be seen that the proposed parking restrictions stop at the very entrance to the cul-de-sac where house Nos 136, 138, 144 and 142 stand.

The proposals DO NOT GO FAR ENOUGH. They should at the very least include all the high-kerb stretches on the side of the cul-de-sac where the houses are situated. That would effectively prevent vehicles parking on both sides of the very narrow cul-de-sac where cars currently regularly park on the pavement in front of the houses. IN ADDITION, no-parking lines should be put at the closed end of the cul-de-sac and for one car's length down the opposite side to ensure that there is an adequate turning space at the end of the cul-de-sac. Presently vehicles that need to turn around not only use the pavement but also use the private driveways of the houses –

Figure 3 shows a Google maps aerial photograph of the cul-de-sac from which it can clearly be seen that there are several cars parked along the kerb opposite the houses. This situation is the norm rather than an exception. What is clear from the aerial photograph is that the cul-de-sac is very narrow and without a turning area at its head necessitates residents having to reverse out the whole length of the cul-de-sac. Furthermore service vehicles have great difficulty accessing the houses, including refuse collectors, ambulance service and regular delivery vans. Should the need arise for a larger service vehicle like a fire engine they simply could not get into the cul-de-sac.

Tonbridge & Malling Borough Council

Proposal for new double yellow lines to prevent obstructive parking (***continued***)

My personal preference would be that restricted parking be imposed along the entire cul-de-sac on both sides.

HOWEVER, I appreciate that this is probably not practical – or at least not expedient. Nevertheless, stopping the restrictions just beyond the apex of the entrance to the cul-de-sac will simply increase the number of cars parked on the pavement and in front of the houses themselves.

Not to extend the yellow lines – at least down the kerb on the side of the houses AND provide for a turning area at the end of the cul-de-sac – will be to show complete disregard and contempt for the homes and quality of life for the residents of the cul-de-sac.

In Figures 4 and 4a, I have shown in yellow/orange the proposal put forward by TMBC. I have added in red what I consider to be the minimum acceptable extension of the parking restrictions (and I am sure the other residents would agree). These changes would ensure ingress and egress for residents together with public and emergency service vehicles while still providing some public car parking amenities.

Figure 3a shows my proposal overlaid on the aerial photograph of the cul-de-sac.

Fig 1

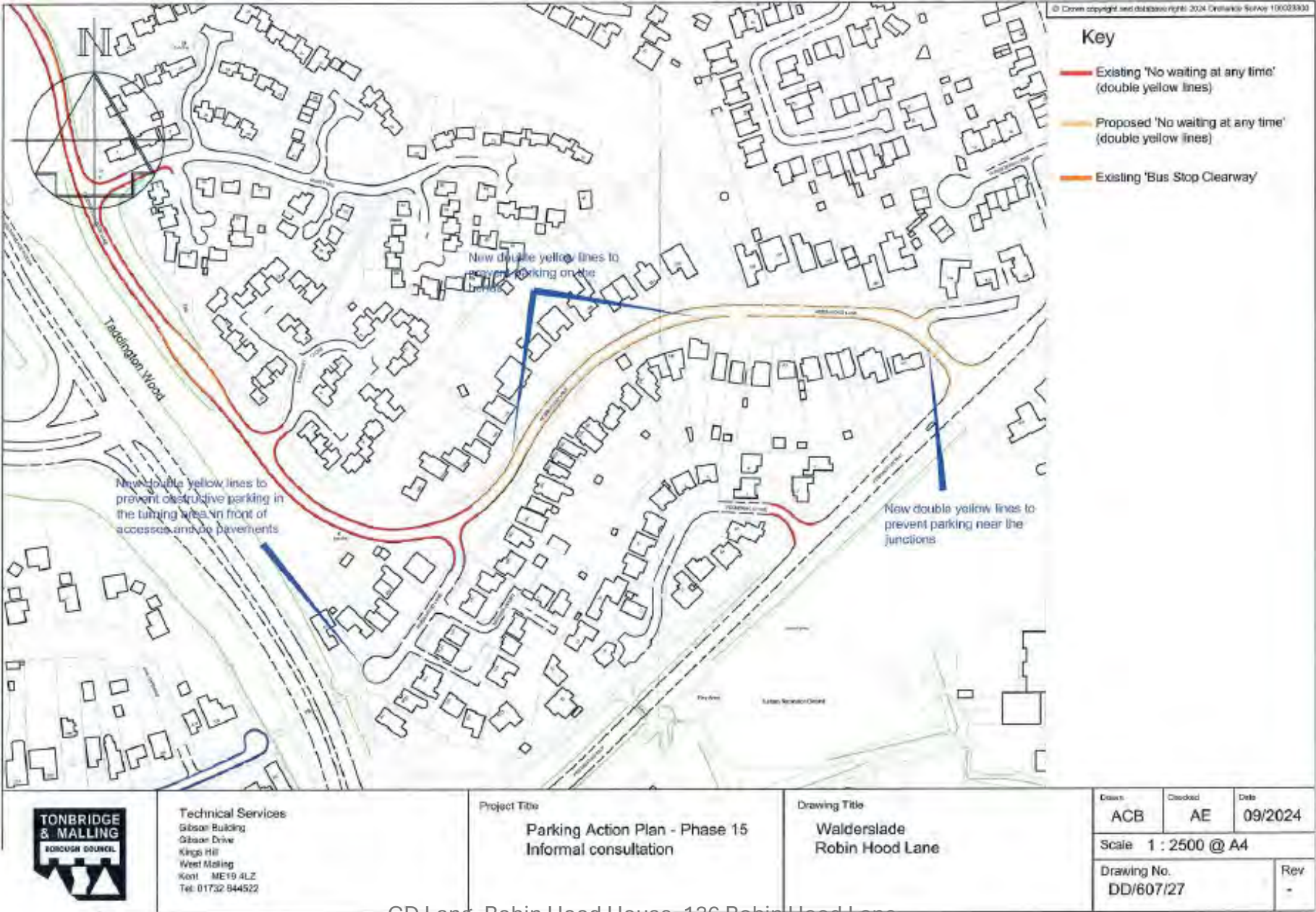

Fig 2



CD Lang, Robin Hood House, 136 Robin Hood Lane,
Chatham, Kent, ME5 9LB

Fig 3



CD Lang, Robin Hood House, 136 Robin Hood Lane,
Chatham, Kent, ME5 9LB

Fig 3a



CD Lang, Robin Hood House, 126 Robin Hood Lane, Google
Chatham, Kent, ME5 9LB

Fig 4



CD Lang, Robin Hood House, 136 Robin Hood Lane,
Chatham, Kent, ME5 9LB

Fig 4a

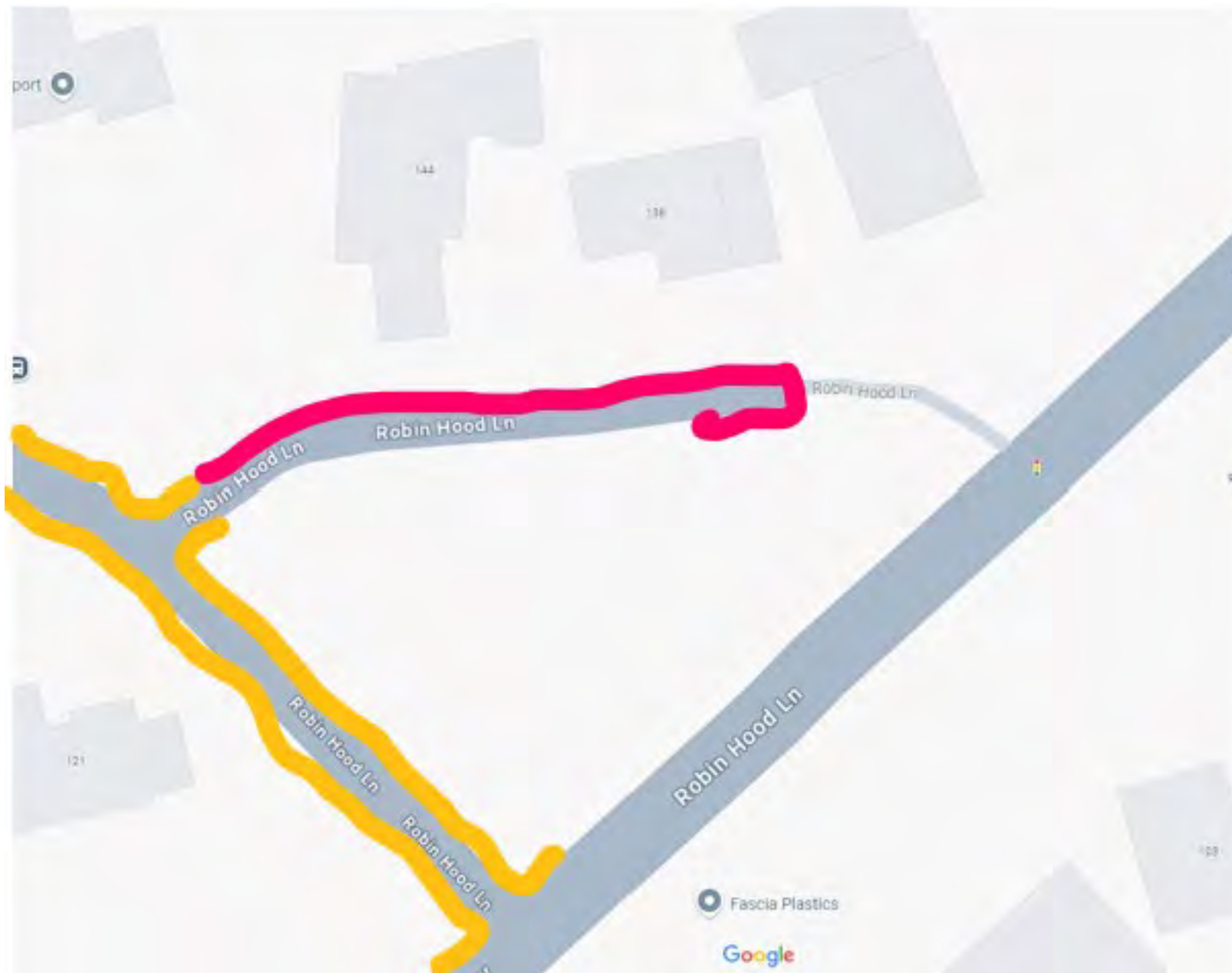

CD Lang, Robin Hood House, 136 Robin Hood Lane,
Chatham, Kent, ME5 9LB

From: [REDACTED]
To: [Parking Office](#)
Subject: DD607-27 Walderslade - Robin Hood Lane
Date: 01 March 2025 12:12:44
Attachments: [TMBC yellow lines.pptx](#)

Dear Sirs,

Ref: DD607-27 Walderslade - Robin Hood Lane

Please find attached a Powerpoint presentation containing the response form provided by TMBC together with my detailed response and recommendations.

While the attached presentation includes photos and diagrams (Figures 1 – 4a) supporting my response, the essence of the text is as follows

Figs 1 & 2 show the planned disposition of double yellow lines proposed by TMBC – it can be seen that the proposed parking restrictions stop at the very entrance to the cul-de-sac where house Nos 136, 138, 144 and 142 stand.

The proposals DO NOT GO FAR ENOUGH. They should at the very least include all the high-kerb stretches on the side of the cul-de-sac where the houses are situated. That would effectively prevent vehicles parking on both sides of the very narrow cul-de-sac where cars currently regularly park on the pavement in front of the houses. IN ADDITION, no-parking lines should be put at the closed end of the cul-de-sac and for one car's length down the opposite side to ensure that there is an adequate turning space at the end of the cul-de-sac. Presently vehicles that need to turn around not only use the pavement but also use the private driveways of the houses – [REDACTED]

Figure 3 shows a Google maps aerial photograph of the cul-de-sac from which it can clearly be seen that there are several cars parked along the kerb opposite the houses. This situation is the norm rather than an exception. What is clear from the aerial photograph is that the cul-de-sac is very narrow and without a turning area at its head necessitates residents having to reverse out the whole length of the cul-de-sac. Furthermore service vehicles have great difficulty accessing the houses, including refuse collectors, ambulance service and regular delivery vans. Should the need arise for a larger service vehicle like a fire engine they simply could not get into the cul-de-sac.

My personal preference would be that restricted parking be imposed along the entire cul-de-sac on both sides.

HOWEVER, I appreciate that this is probably not practical – or at least not expedient. Nevertheless, stopping the restrictions just beyond the apex of the entrance to the cul-de-sac will simply increase the number of cars parked on the pavement and in front of the houses themselves.

Not to extend the yellow lines – at least down the kerb on the side of the houses AND provide for a turning area at the end of the cul-de-sac – will be to show complete disregard and contempt for the homes and quality of life for the residents of the cul-de-sac.

In Figures 4 and 4a, I have shown in yellow/orange the proposal put forward by TMBC. I have added in red what I consider to be the minimum acceptable extension of the parking

restrictions (and I am sure the other residents would agree). These changes would ensure ingress and egress for residents together with public and emergency service vehicles while still providing some public car parking amenities.

Figure 3a shows my proposal overlaid on the aerial photograph of the cul-de-sac.

I trust that your consultation process will pay heed to and act upon my comments and those of other residents – who I know share my views – and that as a result TMBC will modify the current proposals accordingly.

Yours faithfully

[Redacted Signature]

[Redacted Address] Robin Hood Lane ♦ Chatham ♦ Kent ♦ ME5 9LB

Mobile: [Redacted]

Landline: [Redacted]

Email: [Redacted]

This email has been scanned by TMBC before delivery to your mailbox. Please click [here](#) to report this email as spam and help train the filter.

Informal Consultation
New & Amended Parking Restrictions
Robin Hood Lane (and cul-de-sac), WALDESLADE, CHATHAM

Please return this form to;

The Parking Team
 Tonbridge & Malling Borough Council
 Gibson Building, Gibson Drive
 Kings Hill, West Malling
 Kent ME19 4LZ

Alternatively, responses can be sent via email to parking.office@tmbc.gov.uk, quoting reference DD607-27 Walderslade - Robin Hood Lane.

Want to go digital? You can view the proposals and respond online by visiting www.tmbc.gov.uk/parkingphases or scanning this QR code



All responses must be received by 16th March 2024.

Data protection

Please remember that any comments made may be used within reports to Councillors and within documents that may be made available to the public, though any personal information will be protected.

If you would like more information about how we use your data, please read our Privacy Statement on our website www.tmbc.gov.uk/parking

Name (please print)	[REDACTED]
Address	ROBIN HOOD LANE WALDESLADE CHATHAM KENT ME5 9LA
Telephone	[REDACTED]
Email	[REDACTED]

I am (in favour / ~~not in favour~~)* of the Borough Council's proposals for changes to the on-street parking arrangements for Robin Hood Lane (and cul-de-sac), WALDESLADE, CHATHAM shown on plan DD607-27 Walderslade - Robin Hood Lane

* delete where not applicable

Comments	
<p>Driving along this road is so dangerous with the way people park especially on blind bends in the road. Plus they drive so fast down here!</p>	
Signed	Date 21/02/2025

Informal Consultation
New & Amended Parking Restrictions
Robin Hood Lane (and cul-de-sac), WALDESLADE, CHATHAM

Please return this form to;

The Parking Team
Tonbridge & Malling Borough Council
Gibson Building, Gibson Drive
Kings Hill, West Malling
Kent ME19 4LZ

Alternatively, responses can be sent via email to parking.office@tmbc.gov.uk, quoting reference DD607-27 Walderslade - Robin Hood Lane.

Want to go digital? You can view the proposals and respond online by visiting www.tmbc.gov.uk/parkingphases or scanning this QR code



All responses must be received by 16th March 2024.

Data protection

Please remember that any comments made may be used within reports to Councillors and within documents that may be made available to the public, though any personal information will be protected.

If you would like more information about how we use your data, please read our Privacy Statement on our website www.tmbc.gov.uk/parking

Name (please print)	[REDACTED]
Address	ROBIN HOOD LANE WALDESLADE CHATHAM KENT ME5 9LA
Telephone	N/A
Email	[REDACTED]

I am (**in favour** / ~~not in favour~~)* of the Borough Council's proposals for changes to the on-street parking arrangements for Robin Hood Lane (and cul-de-sac), WALDESLADE, CHATHAM shown on plan DD607-27 Walderslade - Robin Hood Lane

* *delete where not applicable*

Comments	
Traffic speed restrictions would be welcomed in addition to parking restrictions Would also like to see bad parking enforced unlike around the school in Tunbury Avenue	
Signature	Date 28/02/25

From: [REDACTED]
To: [Parking Office](#)
Subject: In favour / DD607-27 Walderslade - Robin Hood Lane
Date: 25 February 2025 19:29:08

In favour

DD607-27 Walderslade - Robin Hood Lane

Thank you

This email has been scanned by TMBC before delivery to your mailbox. Please click [here](#) to report this email as spam and help train the filter.

From: [REDACTED]
To: [Parking Office](#)
Subject: DD607-27 Walderslade-Robin Hood Lane
Date: 24 February 2025 14:50:02

Dear Sir' I am in favour with your proposed plans to instal double yellow lines on this busy strech of road.In addition I would suggest that wodden bollards be instaled to protect the grass verge adjacent to the post box.

[REDACTED]

This email has been scanned by TMBC before delivery to your mailbox. Please click [here](#) to report this email as spam and help train the filter.

Informal Consultation
New & Amended Parking Restrictions
Robin Hood Lane (and cul-de-sac), WALDESLADE, CHATHAM

Please return this form to;

The Parking Team
 Tonbridge & Malling Borough Council
 Gibson Building, Gibson Drive
 Kings Hill, West Malling
 Kent ME19 4LZ

Alternatively, responses can be sent via email to parking.office@tmbc.gov.uk, quoting reference DD607-27 Walderslade - Robin Hood Lane.

Want to go digital? You can view the proposals and respond online by visiting www.tmbc.gov.uk/parkingphases or scanning this QR code



All responses must be received by 16th March 2024.

Data protection

Please remember that any comments made may be used within reports to Councillors and within documents that may be made available to the public, though any personal information will be protected.

If you would like more information about how we use your data, please read our Privacy Statement on our website www.tmbc.gov.uk/parking

Name (please print)	[REDACTED]
Address	ROBIN HOOD LANE WALDESLADE CHATHAM KENT ME5 9NL
Telephone	[REDACTED]
Email	[REDACTED]

I am (in favour / ~~not in favour~~)* of the Borough Council's proposals for changes to the on-street parking arrangements for Robin Hood Lane (and cul-de-sac), WALDESLADE, CHATHAM shown on plan DD607-27 Walderslade - Robin Hood Lane

* delete where not applicable

Comments	
Your plan does not show 'Bus Stop Clearway' clearly. Outside [REDACTED] is a stopping point for school buses in the morning. When there are parking problems, I usually clear these by putting a leaflet as attached on screen	
Signed	[REDACTED] Date 11/3/2025

It is not known from where you are coming to park here. It is, however, strongly suggested that you make alternative arrangements.

The area where you are currently parking, apart from not being the most sensible location, on the inside of a bend where other vehicles are accelerating away from a junction, is, during term time, the stopping point for busses transporting school children.

If these have to end up blocking the main carriageway there will be problems with other vehicles and potential difficulties with children talking with their friends, playing with mobiles and tablets, walking into the road and generally not concentrating on what is going around them.

All this could potentially lead to accidents and injuries.

Please find somewhere else to park, thanks.

Informal Consultation
New & Amended Parking Restrictions
Robin Hood Lane (and cul-de-sac), WALDESLADE, CHATHAM

Please return this form to;

The Parking Team
 Tonbridge & Malling Borough Council
 Gibson Building, Gibson Drive
 Kings Hill, West Malling
 Kent ME19 4LZ

Alternatively, responses can be sent via email to parking.office@tmbc.gov.uk, quoting reference DD607-27 Walderslade - Robin Hood Lane.

Want to go digital? You can view the proposals and respond online by visiting www.tmbc.gov.uk/parkingphases or scanning this QR code



All responses must be received by 16th March 2024.

Data protection

Please remember that any comments made may be used within reports to Councillors and within documents that may be made available to the public, though any personal information will be protected.

If you would like more information about how we use your data, please read our Privacy Statement on our website www.tmbc.gov.uk/parking

Name (please print)	[REDACTED]
Address	ROBIN HOOD LANE WALDESLADE CHATHAM KENT ME5 9NL
Telephone	
Email	[REDACTED]

I am (in favour / ~~not in favour~~)* of the Borough Council's proposals for changes to the on-street parking arrangements for Robin Hood Lane (and cul-de-sac), WALDESLADE, CHATHAM shown on plan DD607-27 Walderslade - Robin Hood Lane

* delete where not applicable

Comments	
<p>Regarding changes to on street parking to the above lane. We would welcome the changes. Having experienced near misses with cars and vans parked irresponsibly, this parked with excessive speed of vehicles through the lane, it is surprising there has not been a fatality. The only concern we have is that vehicles that can no longer park on the road will then use our very narrow cul-de-sac to park causing difficulty exiting and entering our driveway (Peters Parking coaching coaches to border)</p>	
Sign	Date 7-3-25

Informal Consultation
New & Amended Parking Restrictions
Robin Hood Lane (and cul-de-sac), WALDESLADE, CHATHAM

Please return this form to;

The Parking Team
 Tonbridge & Malling Borough Council
 Gibson Building, Gibson Drive
 Kings Hill, West Malling
 Kent ME19 4LZ

Alternatively, responses can be sent via email to parking.office@tmbc.gov.uk, quoting reference DD607-27 Walderslade - Robin Hood Lane.

Want to go digital? You can view the proposals and respond online by visiting www.tmbc.gov.uk/parkingphases or scanning this QR code



All responses must be received by 16th March 2024.

Data protection

Please remember that any comments made may be used within reports to Councillors and within documents that may be made available to the public, though any personal information will be protected.

If you would like more information about how we use your data, please read our Privacy Statement on our website www.tmbc.gov.uk/parking

Name (please print)	[REDACTED]
Address	ROBIN HOOD LANE WALDESLADE CHATHAM KENT ME5 9NL
Telephone	[REDACTED]
Email	[REDACTED]

I am (in favour / not in favour)* of the Borough Council's proposals for changes to the on-street parking arrangements for Robin Hood Lane (and cul-de-sac), WALDESLADE, CHATHAM shown on plan DD607-27 Walderslade - Robin Hood Lane

* delete where not applicable

Comments	
WE ARE WHOLLY IN FAVOUR OF THE PROPOSED YELLOW LINES, HOWEVER YOU NEED TO TAKE INTO CONSIDERATION THAT ONCE VEHICLES ARE PROHIBITED TO PARK ALONG THE MAIN STRETCH OF THE ROAD THIS WILL INCREASE THE SPEED IN WHICH THE VEHICLES TRAVEL DOWN & UP THIS ROAD. VEHICLES ALREADY SPEED DANGEROUSLY AS THEY USE THIS ROAD AS A CUT THROUGH.	
Signe	Date
[REDACTED]	

MORE NEEDS TO BE DONE WITH REGARDS TO SPEED RESTRICTIONS. (A RADAR FLASHING SIGN WOULD BE BENEFICIAL) ALSO THE AREAS WHICH WE HAVE HIGHLIGHTED IN PINK WE THINK SHOULD HAVE SINGLE YELLOW LINES WITH PARKING RESTRICTIONS STATING NO PARKING BETWEEN 10-4 MON-FRI.

Key

- Existing 'No waiting at any time' (double yellow lines)
- Proposed 'No waiting at any time' (double yellow lines)
- Existing 'Bus Stop Clearway'

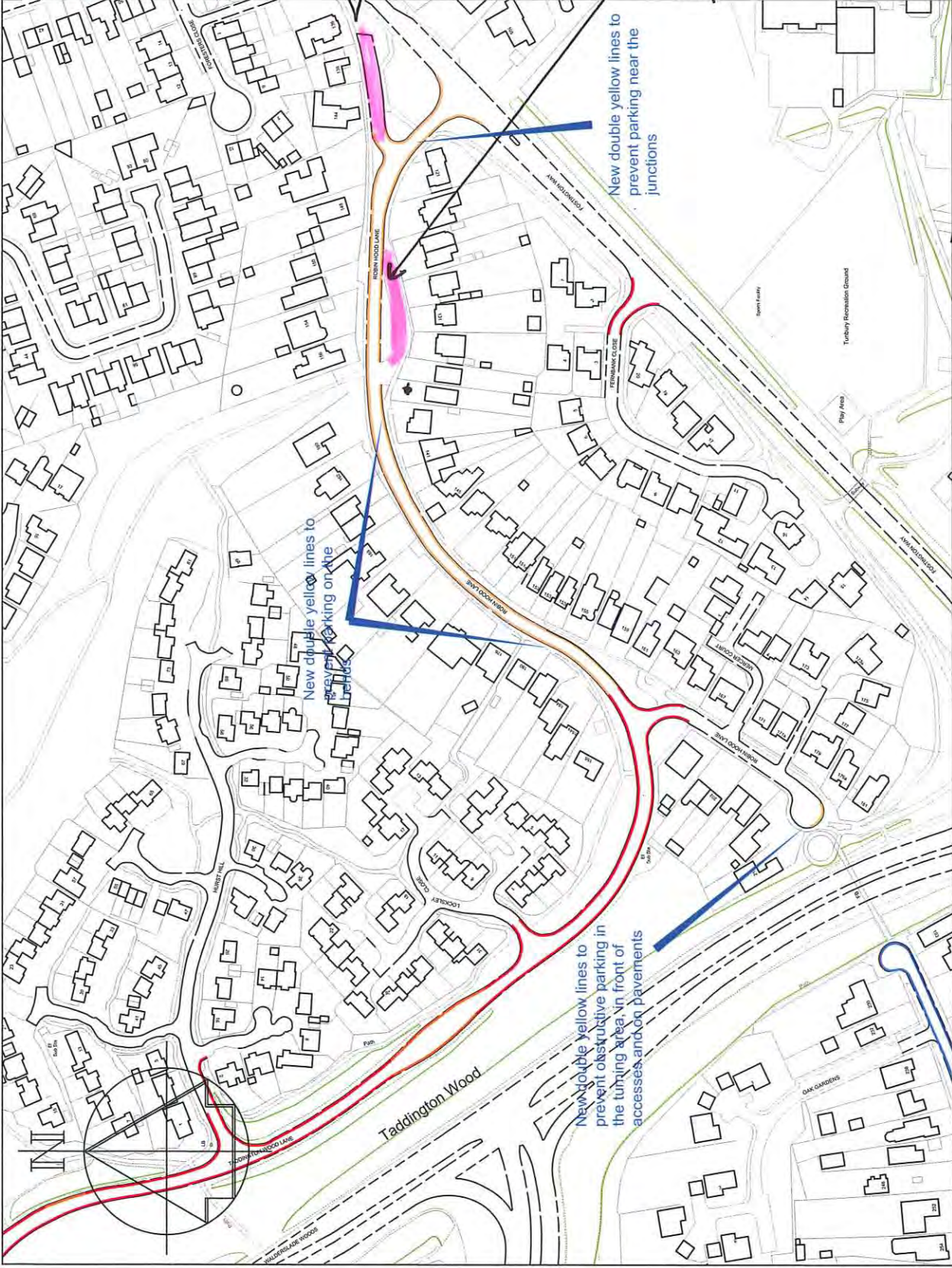

AREA 1
COMMERCIAL VEHICLES
PARK HERE EVERY DAY
BOTH AREAS ARE
BEING USED AS
COMMERCIAL
PICK UP POINTS -

AREA 2
COMMERCIAL VEHICLES
PARK HERE WHEN
THEY HAVE RUN OUT
OF SPACE IN AREA 1

BOTH OF THESE
AREAS WE WOULD
CLASS AS TURNING
AREAS.

CONTINUED IN COMMENTS

Technical Services Gibson Building Gibson Drive Kings Hill West Malling Kent ME19 4LZ Tel: 01732 844522	Project Title Parking Action Plan - Phase 15 Informal consultation		Drawing Title Walderslade Robin Hood Lane		Drawn ACB	Checked AE	Date 09/2024
	TONBRIDGE & MALLING BOROUGH COUNCIL		Scale 1 : 2500 @ A4		Drawing No. DD/607/27		
					Rev -		

Informal Consultation
New & Amended Parking Restrictions
Robin Hood Lane (and cul-de-sac), WALDESLADE, CHATHAM

Please return this form to;

The Parking Team
 Tonbridge & Malling Borough Council
 Gibson Building, Gibson Drive
 Kings Hill, West Malling
 Kent ME19 4LZ

Alternatively, responses can be sent via email to parking.office@tmbc.gov.uk, quoting reference DD607-27 Walderslade - Robin Hood Lane.

Want to go digital? You can view the proposals and respond online by visiting www.tmbc.gov.uk/parkingphases or scanning this QR code



All responses must be received by 16th March 2024.

Data protection

Please remember that any comments made may be used within reports to Councillors and within documents that may be made available to the public, though any personal information will be protected.

If you would like more information about how we use your data, please read our Privacy Statement on our website www.tmbc.gov.uk/parking

Name (please print)	[REDACTED]
Address	[REDACTED] ROBIN HOOD LANE WALDESLADE CHATHAM KENT ME5 9LA
Telephone	[REDACTED]
Email	[REDACTED]

I am **(in favour / ~~not in favour~~)*** of the Borough Council's proposals for changes to the on-street parking arrangements for Robin Hood Lane (and cul-de-sac), WALDESLADE, CHATHAM shown on plan DD607-27 Walderslade - Robin Hood Lane

* *delete where not applicable*

Comments	
<p>I am in favour of the Borough's proposals. Parking on the bend outside 170-172 R.H.L. is dangerous. I've had several narrow squeaks there coming home from the Bridgewood roundabout every weekday morning at 7am. You have to go into the up lane to park. Commuters, who usually have no regard for the speed limits are briefly out of sight because of the dip and the bend. one day there will be a head on collision.</p>	
Signed	<div style="display: flex; justify-content: space-between;"> <div>[REDACTED]</div> <div>Date 24/2/2025</div> </div>

Informal Consultation
New & Amended Parking Restrictions
Robin Hood Lane (and cul-de-sac), WALDESLADE, CHATHAM

Please return this form to;

The Parking Team
 Tonbridge & Malling Borough Council
 Gibson Building, Gibson Drive
 Kings Hill, West Malling
 Kent ME19 4LZ

Alternatively, responses can be sent via email to parking.office@tmbc.gov.uk, quoting reference DD607-27 Walderslade - Robin Hood Lane.

Want to go digital? You can view the proposals and respond online by visiting www.tmbc.gov.uk/parkingphases or scanning this QR code



All responses must be received by 16th March 2024.

Data protection

Please remember that any comments made may be used within reports to Councillors and within documents that may be made available to the public, though any personal information will be protected.

If you would like more information about how we use your data, please read our Privacy Statement on our website www.tmbc.gov.uk/parking

Name (please print)	
Address	ROBIN HOOD LANE WALDESLADE CHATHAM KENT ME5 9NJ
Telephone	
Email	

I am **(in favour / not in favour)*** of the Borough Council's proposals for changes to the on-street parking arrangements for Robin Hood Lane (and cul-de-sac), WALDESLADE, CHATHAM shown on plan DD607-27 Walderslade - Robin Hood Lane

* **delete where not applicable**

Comments	
To Whom it may concern, we live at [redacted] Robin hood lane & we do have problems with people parking outside our property who are either walking dogs or taking children to school on numerous times we have had our drive blocked & been unable to exit	
Signed [redacted]	Date 25-2-25

WE believe your proposal for yellow line
 will just encourage people to park outside
 more i am requested disabled as this
 has caused my problem
 WE believe the solution would be
 resident parking permits on our
 road, yours [redacted]

Informal Consultation
New & Amended Parking Restrictions
Robin Hood Lane (and cul-de-sac), WALDESLADE, CHATHAM

Please return this form to;

The Parking Team
 Tonbridge & Malling Borough Council
 Gibson Building, Gibson Drive
 Kings Hill, West Malling
 Kent ME19 4LZ

Alternatively, responses can be sent via email to parking.office@tmbc.gov.uk, quoting reference DD607-27 Walderslade - Robin Hood Lane.

Want to go digital? You can view the proposals and respond online by visiting www.tmbc.gov.uk/parkingphases or scanning this QR code



All responses must be received by 16th March 2024.

Data protection

Please remember that any comments made may be used within reports to Councillors and within documents that may be made available to the public, though any personal information will be protected.

If you would like more information about how we use your data, please read our Privacy Statement on our website www.tmbc.gov.uk/parking

Name (please print)	[REDACTED]
Address	ROBIN HOOD LANE WALDESLADE CHATHAM KENT ME5 9LB
Telephone	[REDACTED]
Email	[REDACTED]

I am (in favour / ~~not in favour~~)* of the Borough Council's proposals for changes to the on-street parking arrangements for Robin Hood Lane (and cul-de-sac), WALDESLADE, CHATHAM shown on plan DD607-27 Walderslade - Robin Hood Lane

* delete where not applicable

Comments	
<p>Very much in favour. I had raised the issue with previous councillors going back many years. Problems near me are not with residents but with all day parkers. There are times when all day parking causes noise and disturbance from 5.30/6.00 am. Overflow from</p>	
Signed	Date

the cul-de-sac means both sides of the road and the Bus Stop are used. This can make it difficult to safely exit my house as sight lines are obstructed.

24. Feb 2025.

From: [REDACTED]
To: [Parking Office](#)
Subject: DD607-27 Walderslade - Robin Hood Lane
Date: 25 February 2025 08:32:18
Attachments: [image001.png](#)

Hi!

I just wanted to enquire about these proposed parking restriction works. Firstly as a resident (No [REDACTED]) I'm absolutely in favour of them overall.

The only issue I have is why they stop just short of our little cul-de-sac area around 144, 138 etc. ?

A problem exists each weekday daytime where cars end up parked on both sides of this narrow road, blocking and limiting access to our 3 properties driveways' and I fear that by reducing the parking nearby and not also applying the same restrictions along our side of the road might exasperate the issue we already face.

Specifically, as seen in the image below, one side of the road is almost constantly occupied with parked vehicles (workers who commute and vehicle share, parking here all day and jumping in and out of vans to make trips elsewhere). Whilst this is somewhat annoying, it is not a big issue as all four of the properties on our cul-de-sac have extensive off-street parking.

The problem comes when that side is full, and they start parking on the opposing side. This leads to people having to walk into the road, as the footpaths are blocked – and – makes turning in and out of our driveways very (very) difficult). It's not a very wide road in the first place.

So - In my humble opinion, it only needs a few additional meters of restrictions, directly outside our properties and only on one side of the road, as shown below:



I therefore kindly request that this might be considered as part of these upcoming works under DD607-27 ?

Thanks in advance!



[REDACTED]
Technical Director
[REDACTED]
[REDACTED]





This email has been scanned by TMBC before delivery to your mailbox. Please click [here](#) to report this email as spam and help train the filter.

From: [REDACTED]
To: [Parking Office](#)
Subject: RE: DD607-27 Walderslade - Robin Hood Lane
Date: 06 March 2025 07:59:51
Attachments: [image001.png](#)

Hi,

Further to the below, I just wanted to provide a typical example to support my case. This was the situation yesterday (during the day at 13:30, and then in the evening when I tried to leave at 18:00).

It was impossible to make the right turn to exit my property due to the vehicle on the dropped kerb next to my drive and the van opposite. Since the road is a cul-de-sac, turning left is a dead-end.

It also makes it impossible for pedestrians to remain on the pavement.

Additionally my neighbours are all quite elderly, they often require ambulances or support vehicles (shopping deliveries etc.) which are unable to gain access safely.

There is also no way a fire engine could fit through that gap if I struggled with a small car.

Please can something be done about this at the same time, it's actually getting worse.

Thanks in advance!



From: [REDACTED]
Sent: 25 February 2025 08:31
To: 'parking.office@tmhc.gov.uk' <parking.office@tmhc.gov.uk>
Subject: DD607-27 Walderslade - Robin Hood Lane

Hi!

I just wanted to enquire about these proposed parking restriction works. Firstly as a resident (No [REDACTED]) I'm absolutely in favour of them overall.

The only issue I have is why they stop just short of our little cul-de-sac area around 144, 138 etc. ?

A problem exists each weekday daytime where cars end up parked on both sides of this narrow road, blocking and limiting access to our 3 properties driveways' and I fear that by reducing the parking nearby and *not* also applying the same restrictions along our side of the road might exasperate the issue we already face.

Specifically, as seen in the image below, one side of the road is almost constantly occupied with parked vehicles (workers who commute and vehicle share, parking here all day and jumping in and out of vans to make trips elsewhere). Whilst this is somewhat annoying, it is not a big issue as all four of the properties on our cul-de-sac have extensive off-street parking.

The problem comes when that side is full, and they start parking on the opposing side. This leads to people having to walk into the road, as the footpaths are blocked – and – makes turning in and out of our driveways very (very) difficult. It's not a very wide road in the first place.

So – In my humble opinion, it only needs a few additional meters of restrictions, directly outside our properties and only on one side of the road, as shown below:



I therefore kindly request that this might be considered as part of these upcoming works under DD607-27 ?

Thanks in advance!

This email has been scanned by TMBC before delivery to your mailbox. Please click [here](#) to report this email as spam and help train the filter.





Informal Consultation
New & Amended Parking Restrictions
Robin Hood Lane (and cul-de-sac), WALDESLADE, CHATHAM

Please return this form to;

The Parking Team
 Tonbridge & Malling Borough Council
 Gibson Building, Gibson Drive
 Kings Hill, West Malling
 Kent ME19 4LZ

Alternatively, responses can be sent via email to parking.office@tmbc.gov.uk, quoting reference DD607-27 Walderslade - Robin Hood Lane.

Want to go digital? You can view the proposals and respond online by visiting www.tmbc.gov.uk/parkingphases or scanning this QR code



All responses must be received by 16th March 2024.

Data protection

Please remember that any comments made may be used within reports to Councillors and within documents that may be made available to the public, though any personal information will be protected.

If you would like more information about how we use your data, please read our Privacy Statement on our website www.tmbc.gov.uk/parking

Name (please print)	[REDACTED]
Address	ROBIN HOOD LANE WALDESLADE CHATHAM KENT ME5 9NL
Telephone	[REDACTED]
Email	[REDACTED]

I am **(in favour / not in favour)*** of the Borough Council's proposals for changes to the on-street parking arrangements for Robin Hood Lane (and cul-de-sac), WALDESLADE, CHATHAM shown on plan DD607-27 Walderslade - Robin Hood Lane

* delete where not applicable

Comments	
<p>our biggest concern is the speeding along Robin Hood Lane especially from off Fosteringway to Taddingtonwood Road, speeding being from the dip in the road past our property [REDACTED] making it unsafe to exit our drive. on the odd occasion there is a parked car on the road it actually helps to slow the traffic down, so maybe stop + give way would be a better solution to slowing the traffic down as this is a cut through and by putting yellow lines all the way down this will keep the road clear for cars speeding. i can understand the concerns in the cul-de-sac as cars are left there all day when people are picked up to go to work. so many yellow line just there.</p>	
Signed	Date 22/2/25

